

WEST CERMAK ROAD

197' FROM N.E. CORNER OF PROPERTY TO N.E. CORNER OF BUILDING

±200' TO CENTERLINE OF FLORIDA STREET

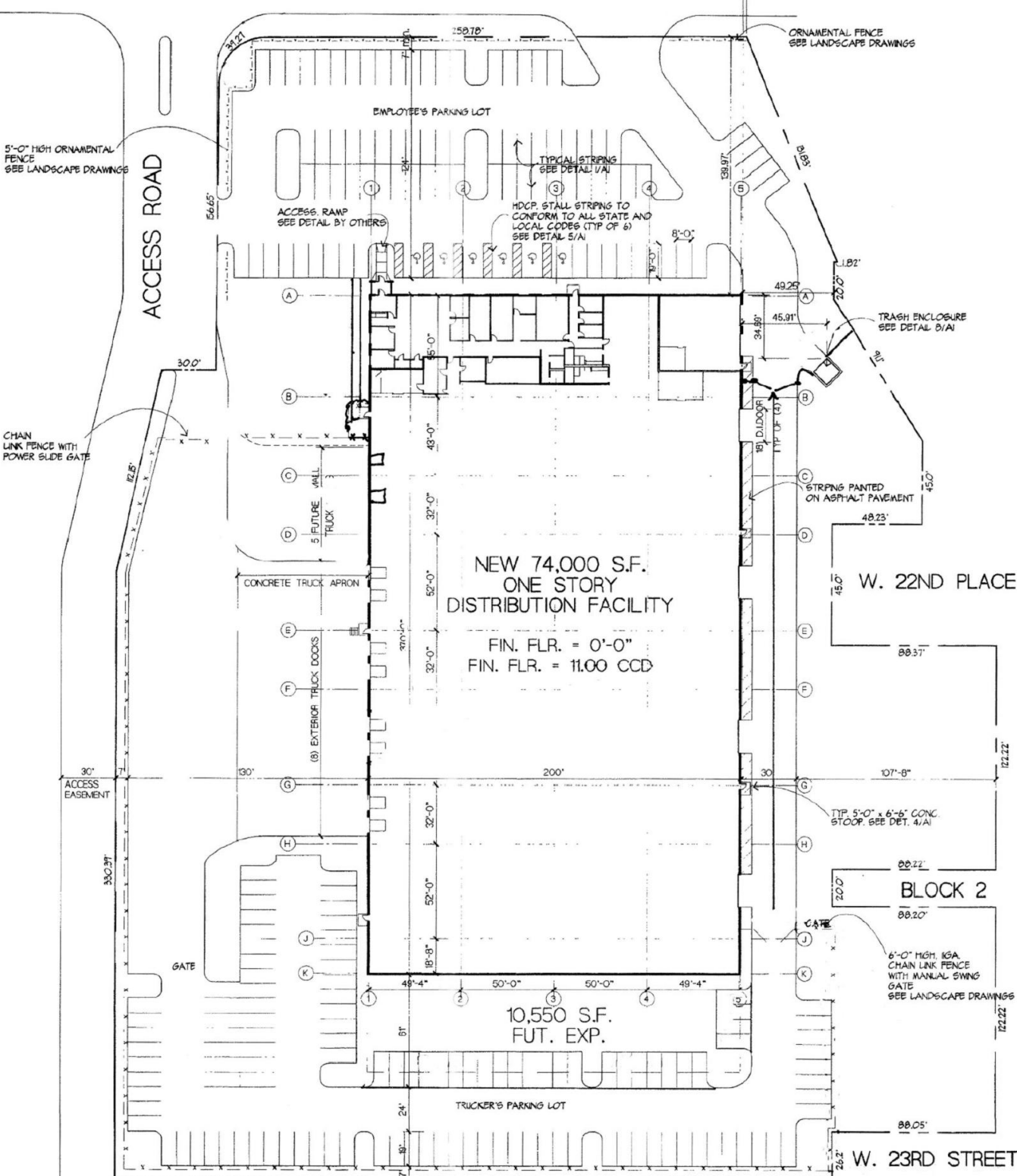

5'-0" HIGH ORNAMENTAL FENCE SEE LANDSCAPE DRAWINGS

ACCESS ROAD

CHAIN LINK FENCE WITH POWER SLIDE GATE

EMPLOYEE'S PARKING LOT

ACCESS RAMP SEE DETAIL BY OTHERS

TYPICAL STRIPING SEE DETAIL 1/A

HDCR STALL STRIPING TO CONFORM TO ALL STATE AND LOCAL CODES (TYP OF 6) SEE DETAIL 5/A

ORNAMENTAL FENCE SEE LANDSCAPE DRAWINGS

TRASH ENCLOSURE SEE DETAIL 8/A

NEW 74,000 S.F. ONE STORY DISTRIBUTION FACILITY

FIN. FLR. = 0'-0"
FIN. FLR. = 11.00 CCD

CONCRETE TRUCK APRON

(B) EXTERIOR TRUCK DOCKS

5' FUTURE TRUCK WELL

STRIPING PAINTED ON ASPHALT PAVEMENT

W. 22ND PLACE

ACCESS EASEMENT

TYP. 5'-0" x 6'-6" CONC. STCOP. SEE DET. 4/A

BLOCK 2

6'-0" HIGH IGA CHAIN LINK FENCE WITH MANUAL SWING GATE SEE LANDSCAPE DRAWINGS

10,550 S.F. FUT. EXP.

TRUCKER'S PARKING LOT

W. 23RD STREET