

# AVAILABLE FOR SUBLEASE



## PROPERTY OVERVIEW

- 60,000 Sq. Ft. Available
- 10,000± Sq. Ft. of Office
- 22' Clear
- 4 Enclosed Docks, 1 DID

**For more information contact:**

**Jeanne Rogers, CCIM SIOR**  
Executive V.P./Partner  
847-627-4223 (direct)  
[jrogers@arthurjrogers.com](mailto:jrogers@arthurjrogers.com)  
[www.arthurjrogers.com](http://www.arthurjrogers.com)

**1800-1802 Brummel Avenue, Elk Grove Village, IL**

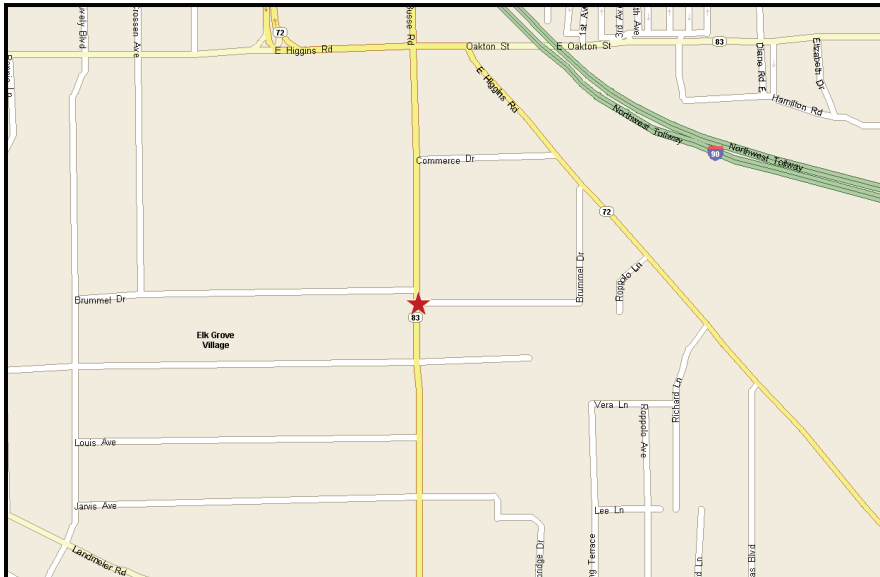

**Arthur J. Rogers & Co. • 3170 Des Plaines Avenue, Des Plaines, Illinois 60018**

*Information shown on this sheet is believed to be accurate and reliable but not guaranteed and is subject to correction.*

**1800-1802 Brummel Avenue  
Elk Grove Village, IL**

*Regent Industrial Center*

**BUILDING/PROPERTY SPECIFICATIONS**

---

**Cook County**

**Available:** 60,000 Square Feet  
**Office:** 10,000 ± Square Feet  
**Built:** 1978  
**Ceiling Height:** 20'6 Clear  
**Loading:** 4 Enclosed Docks, 1 DID (10'x12')  
**Sprinkler:** Wet  
**Lighting:** Fluorescent  
**Power:** 1200amps/480v  
**Sublease Expiration Date:** 11/30/2010



**Contact:** Jeanne Rogers, CCIM SIOR  
847-627-4223  
jrogers@arthurjrogers.com

### Floor Plan

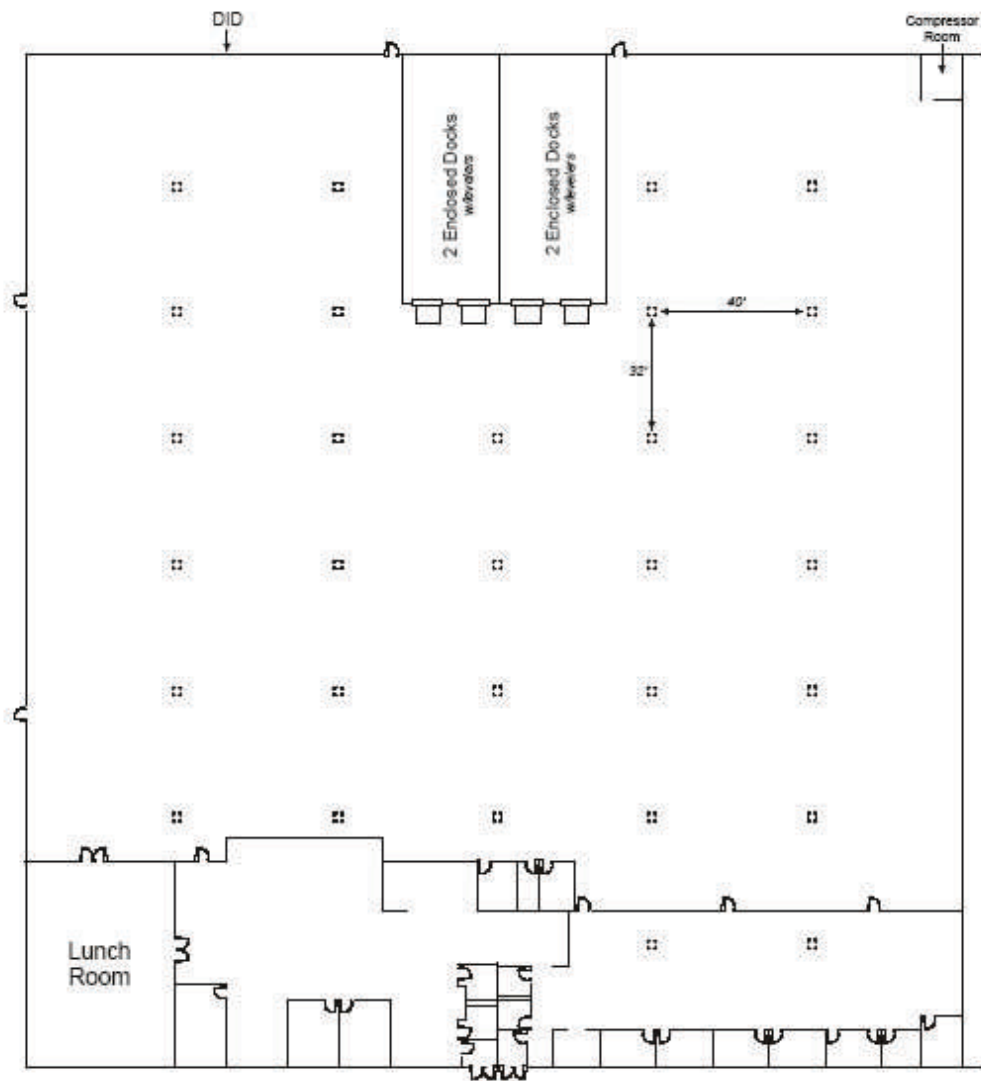

### Site Plan

