

RAILWAY RIGHT OF WAY

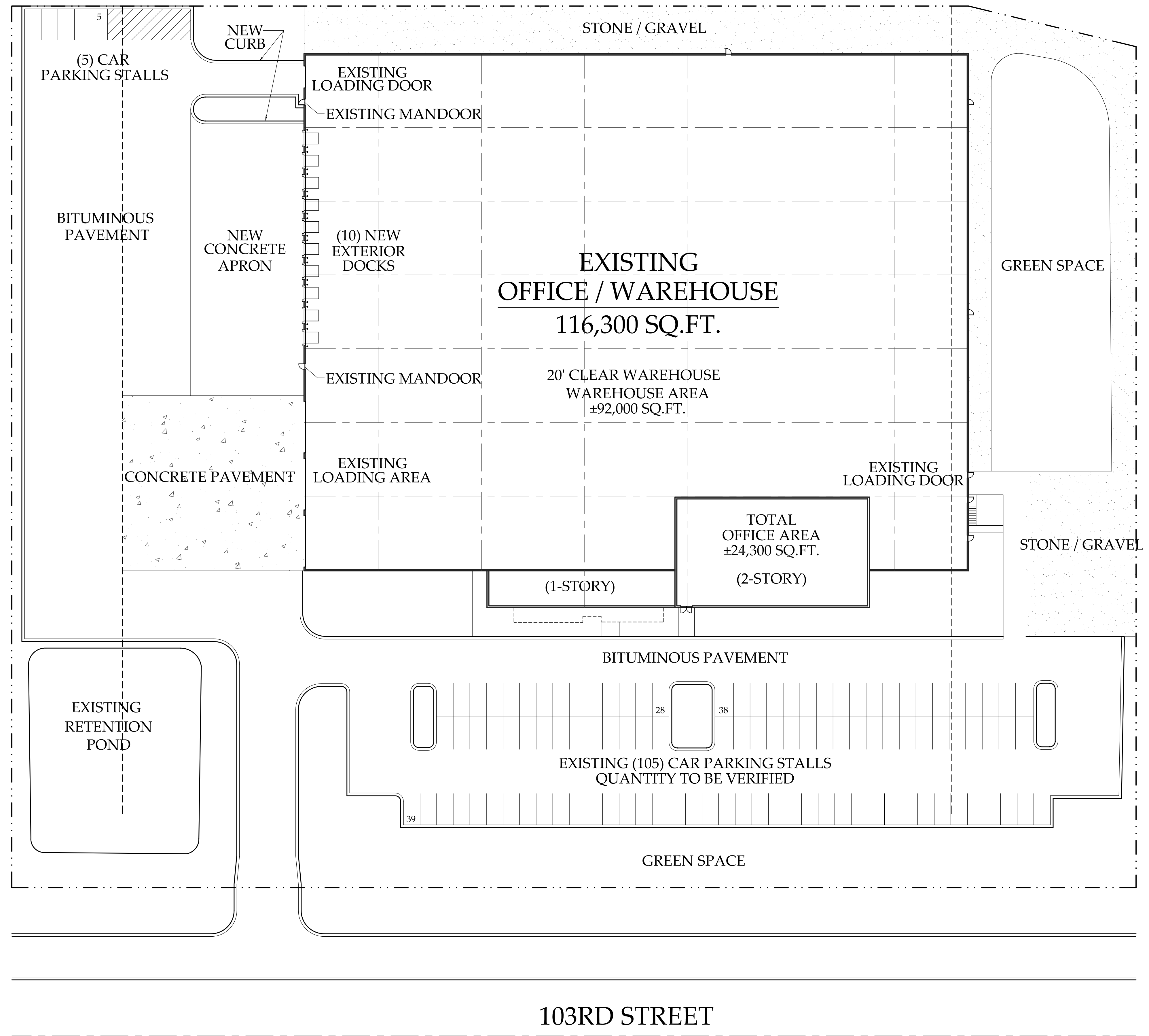

DATA:

SITE AREA:	290,759 SQ.FT.
	6.67 ACRES
BUILDING AREA (GROSS):	116,300 SQ.FT.
EXTERIOR DOCKS:	10 DOCKS
INTERIOR DOCKS:	2 DOCKS
DRIVE-IN-DOORS:	1 DOORS
CAR PARKING:	110 CARS
F.A.R.:	.39
CLEAR HEIGHT:	20 FEET
COLUMN BAYS:	40' X 56'

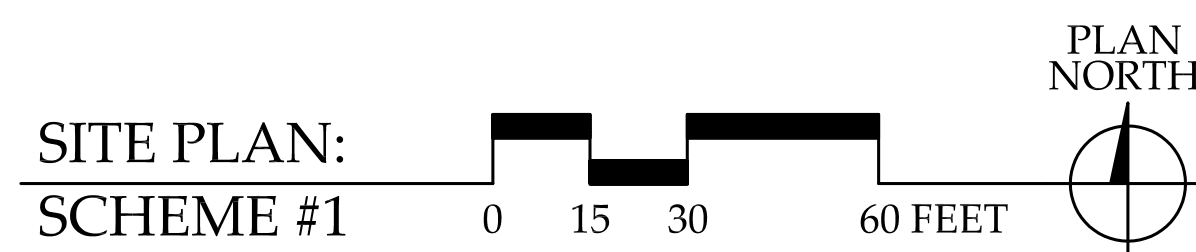

OFFICE / WAREHOUSE FACILITY DOCK EXPANSION

16300 W. 103RD STREET - WOODRIDGE, ILLINOIS

APRIL 4, 2007 #07073

RAILWAY RIGHT OF WAY

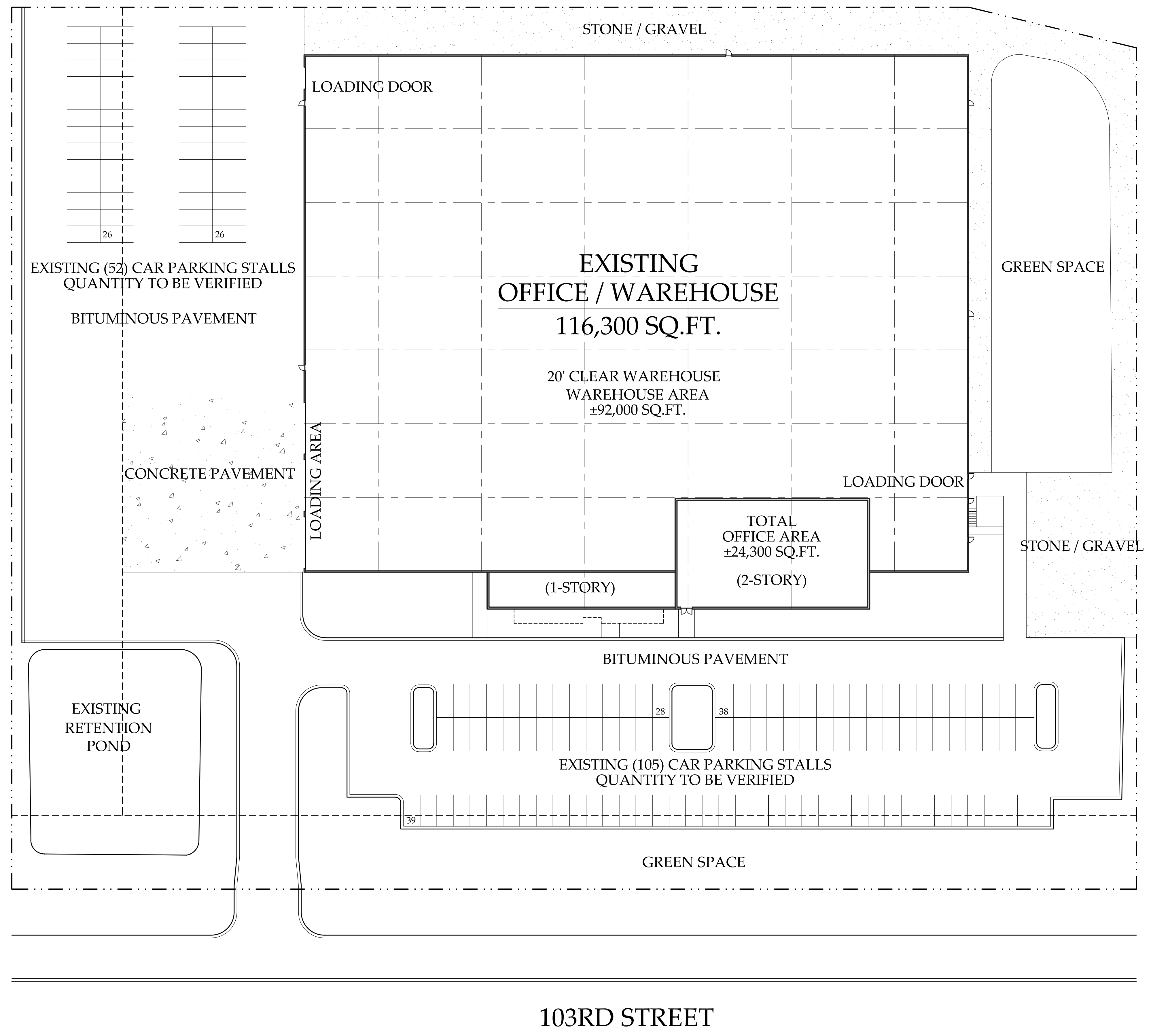

DATA:

SITE AREA:	290,759 SQ.FT.
	6.67 ACRES
BUILDING AREA (GROSS):	116,300 SQ.FT.
EXTERIOR DOCKS:	2 DOCKS
INTERIOR DOCKS:	2 DOCKS
DRIVE-IN-DOORS:	1 DOORS
CAR PARKING:	157 CARS
F.A.R.:	.39
CLEAR HEIGHT:	20 FEET
COLUMN BAYS:	40' X 56'

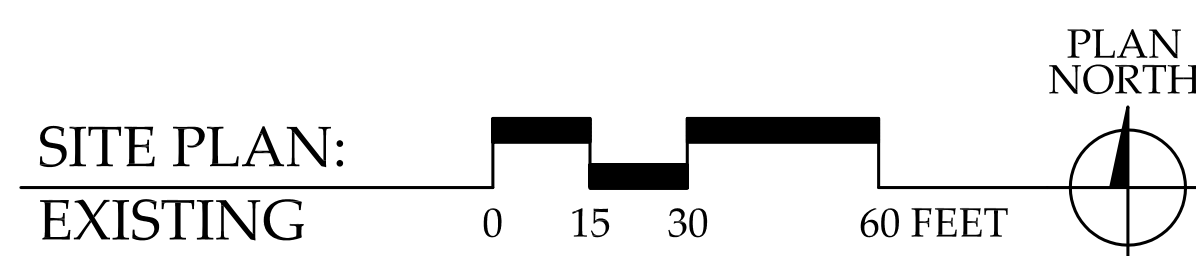

EXISTING OFFICE / WAREHOUSE FACILITY

16300 W. 103RD STREET - WOODRIDGE, ILLINOIS

APRIL 4, 2007 #07073